

Chlamydia and Gonorrhoea testing kit

Penis

This kit should only be used by people who have a **penis**.

Before you start

In this kit you will find items to take a urine sample. Please read and follow the instructions overleaf carefully to do this. Incorrectly collected samples will not be tested.

Please complete the enclosed request form in BLACK ink.

Getting your results

You will usually be contacted by text message or telephone with your results within **two weeks** of us having received your returned samples.

For further results information please visit
<https://ssk.umbrellahealth.co.uk/getting-your-results>



What is chlamydia?

Chlamydia is one of the most common sexually transmitted infections (STIs) in the UK.

Chlamydia is spread through vaginal, oral and anal sex. You can also catch it from sex toys if they are not washed or covered by a new condom each time they are used. You cannot catch it from kissing, toilet seats or sharing towels.

Occasionally it can be passed on fingers to eyes causing eye infections or from a mother to her baby at birth, causing an eye or lung infection in the baby.

What is the treatment for chlamydia?

Chlamydia is treated with antibiotics which we will give you in clinic/pharmacy. If found and treated early it will not cause any problems.

In men chlamydia can cause epididymo-orchitis (painful, swollen testicles) if left untreated, therefore it is important you seek treatment if you have the infection.

If you are treated for chlamydia, it is essential that your partner is also treated before you have sex again.

What is gonorrhoea?

Gonorrhoea is a sexually transmitted infection caused by bacteria called *Neisseria gonorrhoeae*. It is the second most common bacterial sexually transmitted infection in the UK.

Gonorrhoea is easily passed from one person to another during vaginal, oral or anal sex. It can also be spread by sex toys if they are not washed or covered by a new condom each time they are used. It is not passed by kissing, toilet seats or sharing towels.

What is the treatment for gonorrhoea?

Gonorrhoea is easily treated with antibiotics – this is likely to be a combination of an injection and some tablets.

In men, gonorrhoea can cause a painful infection in the testicles and prostate gland if left untreated therefore it is important you seek treatment if you have the infection.

Less commonly, gonorrhoea can cause inflammation of the joints and tendons, skin lesions or, rarely, can affect the brain and heart.

If you are treated for gonorrhoea, it is essential that your partner is also treated before you have sex again.

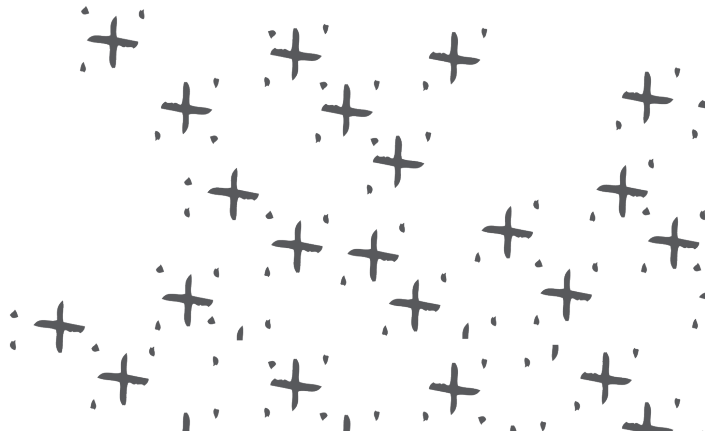

How to collect and send your sample

Urine Sample

- 1 Pee into the urine collection pot provided, first part in the collection pot and the rest in the toilet.



- 2 Remove the lid from the tube with the yellow label. Use the pipette to draw up some of your urine from the collection pot. Squeeze the urine into the tube, filling up between the black fill lines.

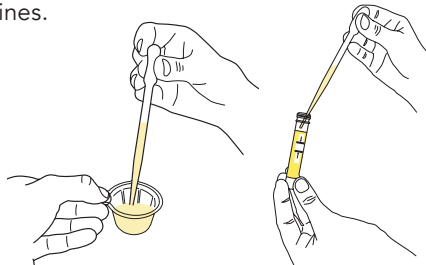

- 3 Screw the lid back onto the tube tightly. Do not pierce the foil cap of the lid.

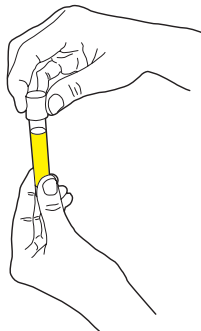

- 4 Write your name and date of sample collection on the tube. Then take the numbered sticker (labelled urine) from the request form and attach this to the tube.

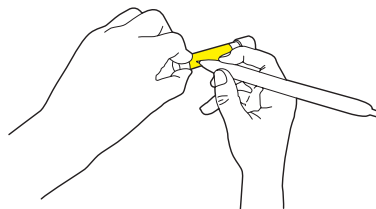

Returning your samples

- 1 Once you have taken your sample, place it in the clear plastic bag containing the absorbent pad and seal it.

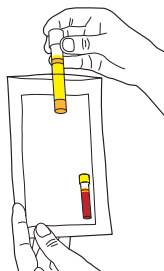

- 2 Put the request form and bag into the box and close it up.

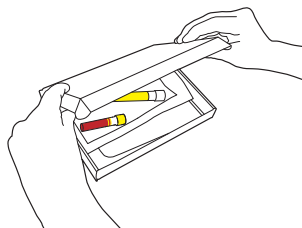

- 3 Put the box into the prepaid envelope, seal the envelope and post immediately.

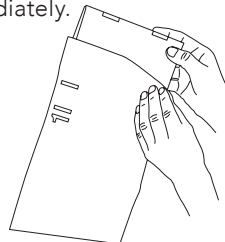

For more information or if you require any assistance **call 0121 237 5700**

PI24/1783/07 Author: Dr Kaveh Manavi Date: June 2022, Reviewed Jara Phatthey Date: April 2023, Review date: 2026